

ROOF DRAIN WITH SUMP PAN

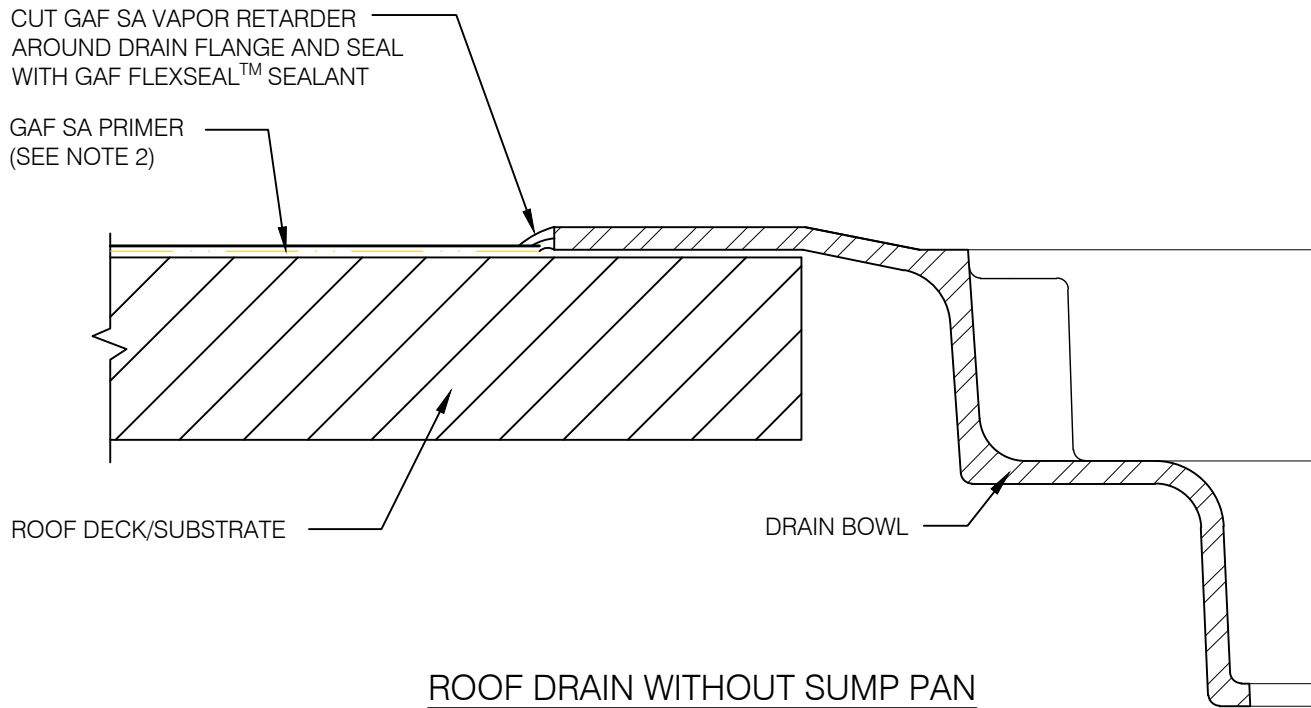

ROOF DRAIN WITHOUT SUMP PAN

NOTES:

1. USE DETAIL IN CONJUNCTION WITH THE STANDARD ROOF EDGE DETAIL FOR APPROVED ROOF SYSTEM.
2. FOR GAF SA VAPOR RETARDER XL, PRIMER IS NOT REQUIRED.
3. REFER TO GAF SA PRIMER INSTALLATION INSTRUCTIONS FOR GENERAL GUIDELINES.
4. MAINTAIN SEPARATION BETWEEN VAPOR RETARDER AND MEMBRANE/ADHESIVE TO AVOID POTENTIAL INCOMPATIBILITY ISSUES.

LEGEND	DRAIN DETAIL			DETAIL
	ROOF AREA	ISSUE DATE	SCALE	513
	PENETRATIONS	7/22/22	N.T.S.	